

# SPECIAL MORTAR COLORS

## PRODUCT DESCRIPTION

**Colors Special Mortar** is a product that comes in various colors, designed especially for the simultaneous laying and grouting of tile pieces.

## COMPOSITION

Selected sand, Portland cement, chemical additives.

## LIMITATIONS

Do not use:

- In greenhouses and pools;
- For overlapped laying;
- On unsteady bases with cracks, hollow sound, displacements, etc.;
- For the technical purpose of waterproofing and on refractory material;
- On wet subfloor or plaster, wait for the base to dry before starting application;
- On bases at temperatures below 0°C and above 40°C during application;
- On wood, parquet, vinyl, metal, fiberglass, particle board, paint, plaster and cement board bases;
- After 2 hours and 30 minutes of mixing.

## ATTENTION

Avoid contact with eyes, skin and clothing during handling. Wear safety glasses, rubber gloves and a mask to avoid inhaling the product. In case of contact with the eyes, rinse immediately with plenty of water and do not induce vomiting in the event of accidental ingestion. In both situations, seek immediate medical help; **KEEP OUT OF THE REACH OF CHILDREN AND ANIMALS.**

## CONSUMPTION

6 to 7 kg/m<sup>2</sup>.

## RELEASE FOR TRAFFIC

Release the area for traffic 7 days after applying the product.

## STORAGE / SHELF LIFE

Store in the original packaging, in a dry place, protected from rain, sun and heat, on pallets and in stacks no more than 1.5 meters high. If stored according to the instructions above, the product has a shelf life of 12 months after the manufacturing date stated on the packaging.

## SURFACE PREPARATION

- The tiles should only be laid after 14 days of base (subfloor) curing, as indicated by the Standards: NBR 7200, NBR 13753, NBR 13755.
- The base surface must be rough and free of cement, moisture, rust stains, grease, efflorescence, release agent, dust and mold. Clean with a wire brush and wash with high-pressure jets to remove all dirt before laying.
- Flatness, waterproofing, cracking and resistance problems must be corrected 72 hours before laying.
- Spacing, movement and structural joints must be brought to the coating surface and filled with deformable material (for example, products based on expanded polyethylene or polyurethane) and then sealed with flexible sealant.
- Perform the grouting simultaneously when laying the pieces, ensuring that the product cures simultaneously in both functions.
- A preliminary test on a small area is recommended to check the finish quality;
- Clean the joints before application to remove any remaining residue;
- Protect friction-sensitive surfaces (aluminum parts, special metal inserts and embossed details) with adhesive tape, as they can get stained and scratched during application;
- Lightly wet the coating surface with clean water before grouting, to facilitate application and keep the ceramic tiles cleaner;
- In extreme conditions (high temperatures, low relative humidity and strong wind) the joints need to be wet with water, without drenching, to ensure grouting adherence.

## PRODUCT PREPARATION AND APPLICATION



1. In a clean, dry metal or plastic container, mix the product manually or mechanically with clean water until it forms a firm paste without any dry lumps. Work with the product protected from the sun, wind and rain, so as not to interfere with the mortar setting time. **DO NOT ADD ANY COMPONENTS OTHER THAN WATER.**

Add 5.2 liters of water for every 20 kg of mortar.  
The acceptable water range is ± 260 ml.



2. Let mortar rest for 10 minutes. Mix again and apply with an appropriate notched trowel.



3. Apply the mortar over the base with the smooth side of the trowel and then pass the notched side over it at a 60° angle to form the laying strips. Return the mortar stuck to the trowel to the container, mix **WITHOUT ADDING WATER** and use again.



4. Place the piece slightly before the final position and drag it to the desired position. Press with your hands and tap all over the piece with a rubber hammer to compress the mortar strips.



5. Apply the coating only on the strips of wet, sticky mortar. When laying, remove some recently placed pieces and check whether the back of the piece is covered with mortar. The more it is filled, the better the adhesion.

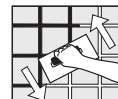

6. Apply the grout with the aid of a rubber trowel using continuous back-and-forth movements in diagonal direction (approx. 45°) on the tile, pressing the mortar into the joints until they are level with the tile edges. We recommend grouting the entire area at once to prevent uneven product drying and affecting the finish;



7. After 15 to 40 minutes or when the mortar is firm, use a sponge moistened with water to gently clean the surface with circular movements. Remove as much of the excess grout as possible to keep the product from sticking to tiles; Repeat the operation until the joints are smooth and at the same level as the tile edges (change the water during this operation, always keeping the sponge clean). If necessary, touch up the joint surfaces, using a rubber trowel and the same mortar.



8. Twelve hours after application, clean the parts with a slightly damp cloth to remove the product mist from the pieces.



9. For final construction site cleaning, 7 days after grouting, use Portokoll® CleanMax Multi-Floor Cleaner.



10. After final cleaning, wait for it to dry completely and apply Portokoll® Sealant to protect the surface against moisture, small mold, oil and dirt stains.



11. Respect the product finishing time, because the grouting may adhere too much to the edge of the piece if this time is exceeded, thus complicating the surface finishing and cleaning stage;



12. Release the area for traffic 7 days after applying the product.

**Wash all tools and application equipment with clean water immediately after use. Hardened/cured material can only be removed mechanically.**