

PROFESSIONAL SPECIAL MORTAR ULTRA FAST TWO-COMPONENT

COMPOSITION

Component A (15.2 kg of powder): formulated based on Portland cement, processed sand and special additives.

Component B (4.8 l of liquid): Acrylic Copolymer and Additives.

PRODUCT DESCRIPTION

Ultra Fast Bicomponent Professional Special Mortar enables FAST RELEASE, extended open time and high resistance for intense movement and vibration requests. This product is industrialized and classified as ACIII, according to NBR 14.081-1. It meets requirements for laying cladding on facades described in NBR 13755.

INDICATION

This product is especially suitable for: environments such as garages, industrial areas, highways, shopping malls, supermarkets, subways and airports, saunas and swimming pools, in:

Conventional laying of ceramics, marbles, natural stones, conventional and large format porcelain tiles (thickness above 7 mm) and extra-fine large format porcelain tiles (from 3 mm to 7 mm) on floors and walls in indoor, outdoor and facades.

Overlying the pieces mentioned in the conventional laying on ceramic tiles, porcelain tiles, granilites and granites, indoors and outdoors, floors and walls (up to 3 m in height).

LIMITATIONS

DO NOT USE:

- On clear natural stones, as they can stain;
- On clear glass mosaic tiles, as they can harm the aesthetics of the settlement;
- For overlying on slate and tiles;
- For overlying in swimming pools and facades;
- In greenhouses;
- As a base level correction function;
- As a technical function of waterproofing and refractory material;
- On a base made of wood, parquet, vinyl, metal, fiberglass, chipboard and paints;
- On a loose base, with cracks, hollow sound, detachment, etc.
- On a very damp subfloor or plaster, wait for the substrate to dry before applying;
- During application, on a base with a temperature below 0°C and above 40°C;
- After 2 hours and 30 minutes of mixing.

CONSUMPTION

Coating format (cm ²)	Format of trowel teeth (mm)	Approximate consumption (kg/m ²)	
		Single layer	*Double layer
Less than 400	6x6x6	4 to 5	5 to 6
Greater than or equal to 400	8x8x8	5 to 6	6 to 8
	10x10x10	6 to 8	8 to 10

Consumption may vary according to the type of trowel used and base conditions.

CLEARANCE FOR TRAFFIC

Construction personnel (carefully)	3 hours, for grouting
Light Traffic	6 to 8 hours after completion of the settlement
Heavy Traffic	72 hours after the completion of the settlement

STORAGE / SHELF LIFE

Store in the original packaging, in a dry place, protected from rain, sun, heat, on pallets and in piles no more than 1.5 meters high. If stored according to the instructions above, the product is valid for 1 (one) year after the manufacturing date shown on the package.

TECHNICAL RECOMMENDATIONS

- The back of the coating must be clean, free of release agent, oil, dirt or any other type of impurity that could harm the integrity of the settlement.
- When laying tiles with formats below 4.5 x 4.5 cm, it is essential to clean the joints well, in order to eliminate mortar remains, to ensure that the grouting is not harmed.
- For installation in cold or refrigerated chambers, it is essential to release for operation only after 28 days after the end of the installation.
- When coating the external walls of barbecue grills, fireplaces and ovens, it is essential that internal walls be coated with refractory

materials, properly laid with PortoKoll® refractory mortar.

- When the wear of the trowel teeth is greater than 1 mm in height, it must be replaced.
- When using the *double layer technique, the mortar must be applied with the notched side of the trowel both on the substrate and on the back of the piece so that the cords are parallel.
- On floors and walls in indoor and outdoor environments, for pieces over 900 cm², the use of *double layer is mandatory.
- On facades, the *double layer is mandatory for 400 cm² slabs and it is recommended to use at least 10 mm notched trowels, in order to minimize the possibility of failure in filling the back area.

LARGE FORMAT LOW THICKNESS LAYING

- The use of large format pieces in facades is conditioned by factors: facade execution project, specification of the adhesive mortar to be used, use of qualified labor, specification of the piece; quality assurance of the application as per specification.
- The substrate must be perfectly flat, as the lack of impregnation of the mortar on the back of the piece impairs its adherence, causes cracks and breakage of the pieces after laying and grouting difficulties due to unevenness.
- It is essential that the maximum unevenness or irregularity of the base is less than 2 millimeters every 2 meters. The verification of flatness must be evaluated throughout the base and, if necessary, correct the flaws before laying. The assessment must be carried out by supporting a 2-meter aluminum ruler on the floor or wall and checking with the aid of a 2 mm spacer if the gaps between the ruler and the floor are greater than 2 mm. If the measurements are above the specified, the base must be regularized.
- Laying should be carried out following the *double layer process. Incorrect laying (lack of mortar) can cause the boards to crack due to the hollow spaces that can be left between the base and the coating.
- For applications in high impact areas, consult the BOT 07 – Portobello manual (item 2 – Material specifications).

SWIMMING POOL TREATMENT

- Good water quality is maintained through constant maintenance, and is essential for the durability of the mortar and grout. The chemical balance of the swimming pool water is obtained by keeping the pH, the total alkalinity, free chlorine and the calcium hardness within the standards established in the swimming pool regulations. In case of doubt, consult a specialist in swimming pool treatment.

BASE PREPARATION

Conventional settlement:

- The laying of the coating should only be done after 14 days of curing the base (subfloor), as indicated in the Standards: NBR 7200, NBR 13753, NBR 13754, NBR 13755.
- The surface of the base must be rough and free from cement cream, moisture, rust stains, grease, efflorescence, mold release residues, dust and mildew. Clean with a steel brush and wash with high pressure jets to remove any type of dirt before laying.
- Flatness, waterproofing, cracking and resistance problems must be corrected 72 hours before laying.
- The absorption of the base must be evaluated before laying by spraying water on the surface. If water is absorbed in less than 60 seconds, there will be loss of adhesion. In this case and when the place is subject to sun and wind, the base should be moistened, but without soaking.
- Spacing, movement and structural joints must be brought to the lining surface and filled with deformable material (eg polyethylene or expanded polyurethane based products) and then sealed with flexible sealant.
- Protect friction-sensitive surfaces (aluminum parts, special metal appliques and embossed details) with adhesive tape, as they may be stained and scratched during the application of the mortar.

PROFESSIONAL SPECIAL MORTAR ULTRA FAST TWO-COMPONENT

Overlaying Settlement:

- Evaluate the flatness of the base to be covered, checking if the old pieces are well bonded. If some of the pieces are loose, they must be replaced with the special Ultra Bicomponent Rapid mortar 24 hours before the start of overlaying.
- Plan for the new parts to be placed in a different position than the old one so that the old and new joints do not overlap.
- For overlaying on granilite, granitine, burnt cement and waxed floors, apply a mechanical sanding treatment to make the surface rough to facilitate the adhesion of the adhesive mortar.
- To remove any type of dirt that could harm the surface to be coated with the CleanMax Portokoll Multifloor Cleaner 48 hours before laying the pieces.
- Check the height of electrical boxes, hydraulic points and baseboards, base thickness.
- For overlapping walls, after cleaning the base to be laid, use a support ruler to contain the sliding of the pieces. The support ruler removal time is 48 to 72 hours.

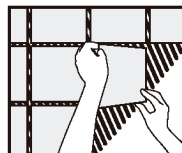
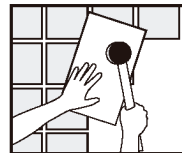

PRODUCT PREPARATION AND APPLICATION



1. In a clean and dry plastic or metal container, preferably mechanically mix the entire contents of the packaging: 15.2 kg of component A (powder) plus 4.8 liters of component B (liquid) until it forms a pasty, firm mass without dry lumps. Work with the product protected from sun, wind and rain, so as not to interfere with the mortar setting time.



NEVER ADD WATER TO THE MIXTURE AND NEVER FRACTION THE CONTENT OF THE PACKAGE.

2. Allow for the mortar to rest for 10 minutes. Mix again and apply with an appropriate notched trowel.

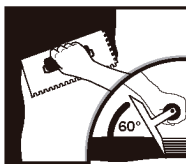

3. Spread the mortar over the base with the smooth side of the trowel and then pass the serrated side at an angle of 60° to form the laying cords.



4. When the *double layer technique is needed, also apply mortar on the back of the piece and lay so that the strips are parallel to the strips on the base. Return the mortar stuck to the trowel to the container, mix **WITHOUT ADDING WATER** and use again.

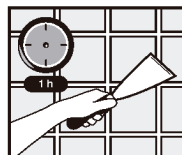

5. Place the piece 5 cm before the final position and drag it to the desired position. Press it with your hands and hit the entire piece with a rubber mallet to crush the mortar strips. In cases and fine porcelain tiles, it is recommended to use suction cups on large-format pieces to facilitate the sliding of the piece and use it to beat a rubber trowel to crush the mortar cords so as not to break the piece.
6. Lay the coating only on the strips of wet, sticky mortar. During laying, remove some newly placed pieces and check if the back of the piece is covered with mortar. The more bonded the mortar, the better the adhesion.
7. Clean the joints after laying the pieces, removing excess mortar to facilitate grouting. Protect the area from sun, rain and wind for 3 hours. After this period, grouting can be performed.
8. To grout, use Portobello grout.
9. For final cleaning, 7 days after grouting, use PortoKoll® CleanMax Multi-Floor Cleaner.
10. After final cleaning, wait for the grout to dry completely and apply PortoKoll® CleanMax Sealer to protect the surface against moisture, small mold stains, oil and dirt, if the chosen grout is cementitious.