

# MAXIMUM WHITE BONDING MORTAR

## PRODUCT DESCRIPTION

**Maximum White Special Bonding Mortar** is a white bonding mortar with high adhesion power and flexibility.

This industrial product is classified as ACIII, according to ABNT NBR 14.081-1. It meets the requirements for laying facade coverings described in NBR 13755.

It has Dual Mix technology, which can be prepared in two ways:

*Conventional Consistency*: for conventional laying on indoor and outdoor floors / walls and facades.

*Fluid Consistency*: for laying conventional floors in indoor and outdoor areas. The fluid consistency makes it easier to apply.

## INDICATION

Laying ceramic tiles, glazed porcelain tiles, technical porcelain tiles, large-format pieces up to 120x240 cm (28,800 cm<sup>2</sup>), porcelain glass tiles, granite, marble and stones on floors and walls in indoor areas, outdoor floors, saunas, and swimming pools;

Ceramic tiles, glazed porcelain tiles, technical porcelain tiles measuring up to 60x120 cm (7200 cm<sup>2</sup>) on facades up to 6 m in height.

## COMPOSITION

It is formulated based on select sand, White Portland Cement and special chemical additives.

## LIMITATIONS

This product should not be used:

- For overlapped laying;
- On transparent glass tiles, as they can damage the laying aesthetics;
- In greenhouses;
- On wood, parquet, vinyl, metal, fiberglass, particle board, paint, plaster and cement board bases;
- For the technical purpose of waterproofing and on refractory material;
- On unsteady bases with cracks, hollow sound, displacements, etc.;
- On a very wet subfloor or plaster, wait for the base to dry before starting the application;
- During application, on bases at temperatures below 0°C and above 40°C;
- After 2 hours and 30 minutes of mixing.

## ATTENTION

Avoid contact with eyes, skin and clothing during handling. Wear safety glasses, rubber gloves and a mask to avoid inhaling the product. In case of contact with the eyes, rinse immediately with running water and do not induce vomiting in the event of accidental ingestion. In both situations, seek immediate medical help; **KEEP OUT OF THE REACH OF CHILDREN AND ANIMALS.**

## CONSUMPTION

Coating format (cm <sup>2</sup> )	Format of trowel notches (mm)	Approximate consumption (kg/m <sup>2</sup> )	
		Single layer	*Double layer
Smaller than 400	6x6x6	4 to 5	5 to 6
Greater than or equal to 400	8x8x8	5 to 6	6 to 8
	10x10x10	6 to 8	8 to 10

*Consumption may vary according to the type of trowel used and base conditions.*

## RELEASE FOR TRAFFIC

Construction personnel (carefully)	72 hours, for grouting
Light Traffic	7 days after laying
Heavy Traffic	14 days after laying

## STORAGE / SHELF LIFE

Store in the original packaging, in a dry place protected from rain, sun and heat, on pallets and in stacks of 1.5 meters maximum height. If stored according to the instructions above, the product is valid for one (1) year after the manufacturing date shown on the packaging.

## TECHNICAL RECOMMENDATIONS

- The back of the coating must be clean, free of release agent, oil, dirt or any other type of impurity that could damage the integrity of the laid base.
- When laying tiles measuring less than 4.5x4.5 cm, it is essential to clean the joints properly so as to eliminate mortar residue and ensure that the grouting is not affected.
- When laying in walk-in coolers or refrigerators, the area should only be released for operation 28 days after laying is complete.
- When coating the external walls of barbecue grills, fireplaces and ovens, it is essential that internal walls be coated with refractory materials, properly laid with PortoKoll® Refractory mortar.
- When the wear on the trowel notches exceeds 1 mm in height, it should be replaced.
- When using the \*double layer technique, the mortar should be applied with the notched side of the trowel on both the substrate and the back of the piece so that the strips are parallel.
- On floors and walls of indoor and outdoor environments, for pieces over 900 cm<sup>2</sup>, using a \*double layer is mandatory.
- For facades, the \*double layer is mandatory for 400 cm<sup>2</sup> tiles and the use of notched trowels with a radius of 10 mm is recommended to minimize the possibility of backfilling failure.
- Details about the coating design should be discussed with the planner.

## BASE PREPARATION

- The coating should only be laid after 14 days of base (subfloor) curing, as indicated by the Standards: NBR 7200, NBR 13753, NBR 13754, NBR 13755.
- The base surface must be rough and free of cement, moisture, rust stains, grease, efflorescence, release agent, dust and mold. Clean with a wire brush and wash with high-pressure jets to remove all dirt before laying.
- Flatness, waterproofing, cracking and resistance problems must be corrected 72 hours before laying.
- Base absorption must be evaluated before laying the mortar by spraying water on the surface. If the water is absorbed in less than 60 seconds, there will be loss of adhesion. In this case and when the location is subject to sun and wind, the base should be moistened, but without drenching.
- Spacing, movement and structural joints must be brought to the coating surface and

filled with deformable material (for example, products based on expanded polyethylene or polyurethane) and then sealed with flexible sealant.

- Protect friction-sensitive surfaces (aluminum parts, special metal inserts and embossed details) with adhesive tape, as they can get stained and scratched during mortar application.

## PRODUCT PREPARATION AND APPLICATION



1. In a clean, dry, metal or plastic container, mix the product manually or mechanically with clean water until it forms a firm paste without any dry lumps. Work with the product protected from sun, wind and rain, so as not to interfere with the mortar setting time. **DO NOT ADD ANY COMPONENTS OTHER THAN WATER.**

CONSISTENCY	Itupeva	Joinville	Goiânia	Cravinhos	Itaboraí
Conventional	5.6 liters	4.2 liters	5.8 liters	5.6 liters	5.6 liters
	Maximum addition of 500 ml of water				
Fluid	6.2 liters	4.8 liters	6.4 liters	6.2 liters	6.2 liters
	Maximum allowed addition: 1 liter of water				



2. Let mortar rest for 10 minutes. Mix again and apply with an appropriate notched trowel.



3. Apply the mortar over the base with the smooth side of the trowel and then pass the notched side over it at an angle of 60° to form the laying strips.



4. When the \*double layer technique is needed, also apply mortar on the back of the piece and lay so that the strips are parallel to the strips on the base. Return the mortar stuck to the trowel to the container, mix WITHOUT ADDING WATER and use again.



5. Place the piece just before its final position and drag it to the desired position, press with your hands and tap all over the piece with a rubber hammer to compress the mortar strips.

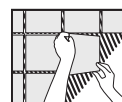

6. Lay the coating only on the strips of wet, sticky mortar. When laying, remove some recently placed pieces and check whether the back of the piece is covered with mortar. The more bonded mortar, the better the adhesion.



7. Clean the joints after laying the pieces, removing excess mortar to facilitate grouting. Protect the area from the sun, rain and wind for 72 hours. After this period, grouting can be performed.



8. For grouting, use Portobello grout.



9. For final construction site cleaning, 7 days after grouting, use PortoKoll® CleanMax Multi-Floor Cleaner.



10. After final cleaning, wait for the grout to dry completely and apply PortoKoll® CleanMax Sealer to protect the surface against moisture, small mold stains, oil and dirt, if the chosen grout is cementitious.